

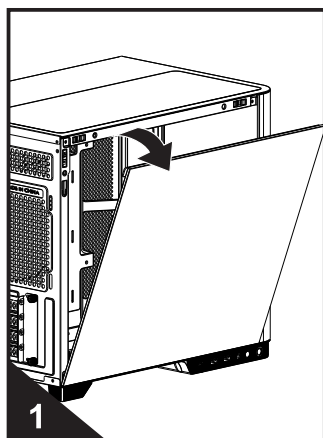

valuetop.com.bd/download

Please download and install the temperature display software

1 Disassembly of left tempered glass side panel, front tempered glass panel and right side panel.



Break up the tempered glass outward according to the arrow direction to disassemble the left tempered glass as shown in illustration.

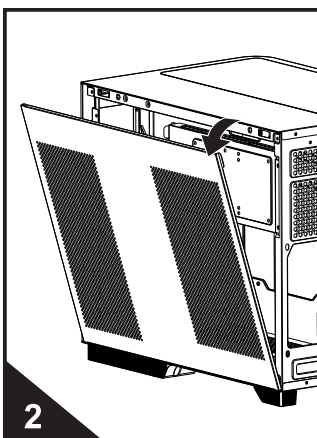

Break up the from the front tempered glass(or mesh front panel)outward according to the arrow direction to disassemble it as shown the illustration.

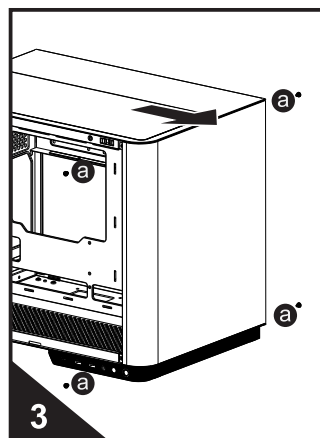

Unscrew the screws of "a" positions, then take out the front tempered glass according to arrow direction.

2 PSU installation (support ATX PSU)

Install PSU in the position as shown in the illustration, then fix it by 4 screws at "a" positions.

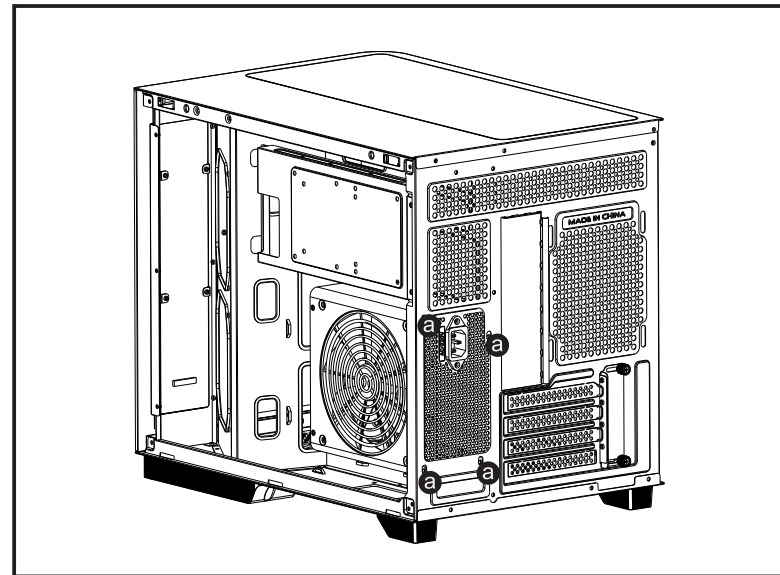

3 M/B installation (support M/B back plug)

Put M/B in the case and align the screw holes, then fix M/B by screws as shown in the following illustration (this case support micro ATX and ITX M/B).

(different M/B has different installation characteristics, please refer to the user manual of your M/B before installation.)

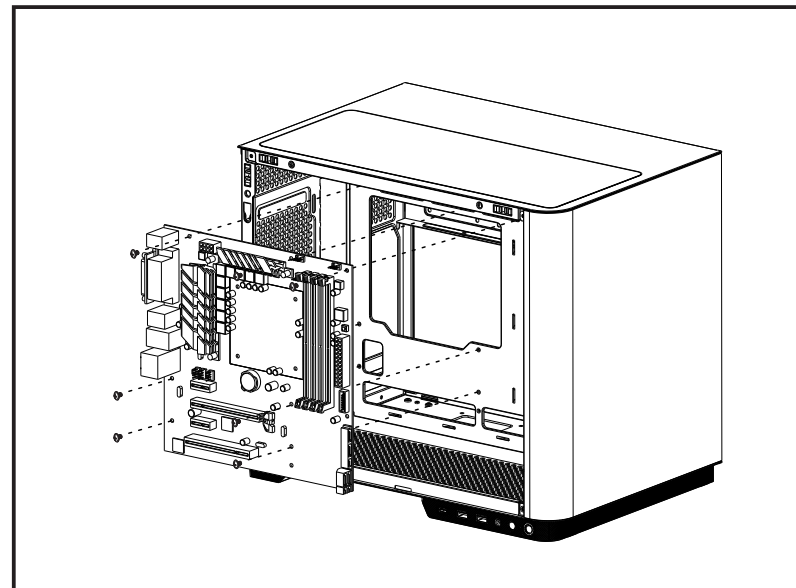

4 VGA card installation

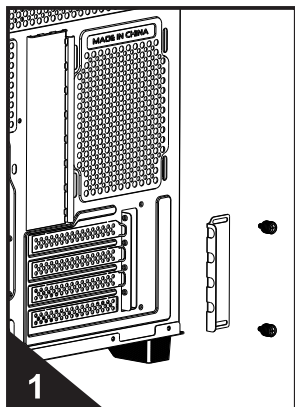

1 Unscrew the screws of the fastening bar of the PCI slot covers, remove the fastening bar.

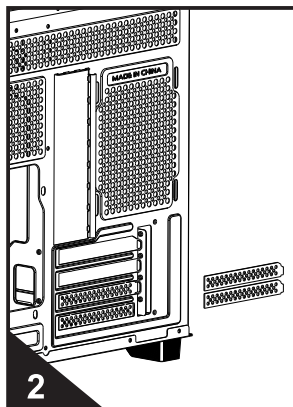

2 Break off PCI slot cover(s) of the corresponding positions.

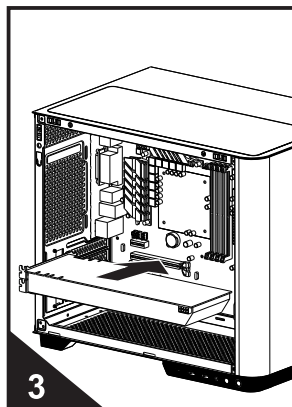

3 Insert VGA card into the slot of M/B according to the arrow direction; Fix VGA card by screws.

5 HDD/SSD installation (support HDD*1+SSD*2 or HDD*1+SSD*3)

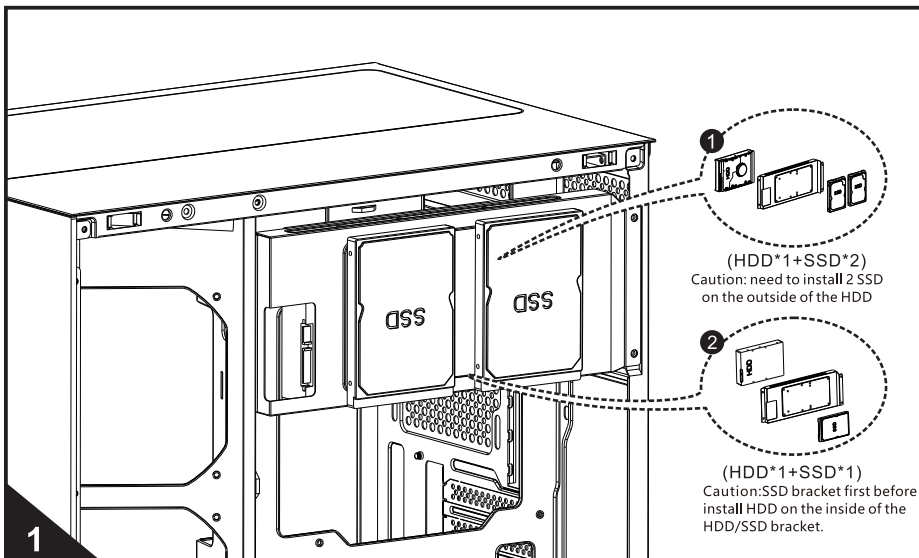

- ① Unscrew the screws of "a" positions and "b" positions of the HDD/SSD bracket, knock down the bracket.
- ② Install 1*3.5" HDD + 2*2.5" SSD (figure 1) or 1*3.5" HDD + 1*2.5" SSD (figure 2) on the HDD/SSD bracket.
- ③ Re-install the HDD/SSD bracket to its original position, and secure it by screws at "a" positions and "b" positions.

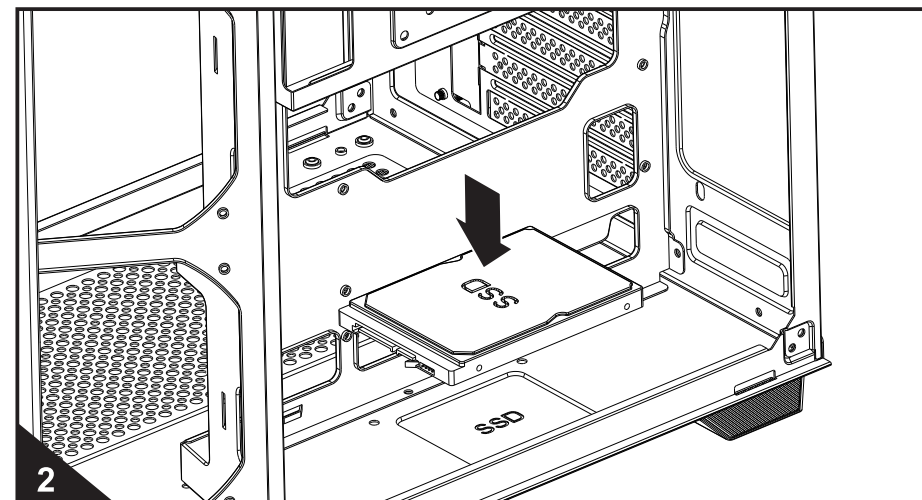

Put 2.5" SSD*1 on bottom panel, secure it by screws from the bottom.

6 Cooling device compatible

Top panel: 3x12cm fan or 1x360 water cooling kit
 M/B bracket: 2x12cm fan or 1x240 water cooling kit.
 Bottom panel: 3*12cm fan
 Rear panel: 1x12cm fan